



Immersion Transducers

The **Slimline Housing Style (ISL)** is an excellent choice for most immersion testing applications. This style will accommodate element diameters up to 1/2" and features a stainless steel housing for rugged dependability.

The **Right Angle Housing Style (IRA)** is an excellent choice when the application requires a sound path at a right angle to the connector such as thru-transmission testing or testing inside the diameter of bore holes or limited access areas. This style will accommodate element diameters up to 1/2" and features a stainless steel housing for rugged dependability.

The ISL and IRA Housing Styles both feature waterproof UHF connectors and epoxy lenses to optimize performance and durability. Spherical or cylindrical focusing is available to increase sensitivity to critical flaws or to improve near-surface resolution. Please refer to the chart on page 22 for practical focusing limits.

A **Right Angle Reflector (ISL-RA)** is available for the ISL Transducer to direct the sound beam 90° into hard to reach areas. Other angles are available on request.

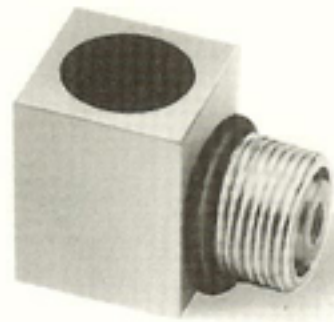

Frequency (MHz)	Element Diameter		
	.250"	.375"	.500"
General Purpose Series (GP)			
1.0	_____	_____	ISL-0104-GP IRA-0104-GP
2.25	ISL-0202-GP IRA-0202-GP	ISL-0203-GP IRA-0203-GP	ISL-0204-GP IRA-0204-GP
3.5	ISL-0302-GP IRA-0302-GP	ISL-0303-GP IRA-0303-GP	ISL-0304-GP IRA-0304-GP
5.0	ISL-0502-GP IRA-0502-GP	ISL-0503-GP IRA-0503-GP	ISL-0504-GP IRA-0504-GP
10.0	ISL-1002-GP IRA-1002-GP	ISL-1003-GP IRA-1003-GP	ISL-1004-GP IRA-1004-GP
Very High Resolution Series (VHR)			
10.0	ISL-1002-VHR IRA-1002-VHR	ISL-1003-VHR IRA-1003-VHR	ISL-1004-VHR IRA-1004-VHR
15.0	ISL-1502-VHR IRA-1502-VHR	ISL-1503-VHR IRA-1503-VHR	_____
20.0	ISL-2002-VHR IRA-2002-VHR	_____	_____
25.0	ISL-2502-VHR IRA-2502-VHR	_____	_____
High Resolution Series (HR)			
2.25	ISL-0202-HR IRA-0202-HR	ISL-0203-HR IRA-0203-HR	ISL-0204-HR IRA-0204-HR
3.5	ISL-0302-HR IRA-0302-HR	ISL-0303-HR IRA-0303-HR	ISL-0304-HR IRA-0304-HR
5.0	ISL-0502-HR IRA-0502-HR	ISL-0503-HR IRA-0503-HR	ISL-0504-HR IRA-0504-HR
10.0	ISL-1002-HR IRA-1002-HR	ISL-1003-HR IRA-1003-HR	ISL-1004-HR IRA-1004-HR
15.0	ISL-1502-HR IRA-1502-HR	ISL-1503-HR IRA-1503-HR	_____
20.0	ISL-2002-HR IRA-2002-HR	_____	_____
25.0	ISL-2502-HR IRA-2502-HR	_____	_____

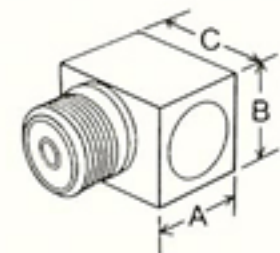
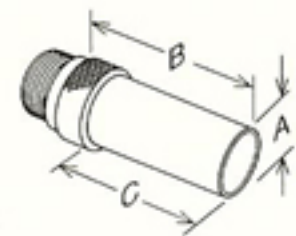

DIMENSIONS (ISL)		
A	B	C
.625"	1.675"	1.360"

DIMENSIONS (IRA)			
Element	A	B	C
.250"	.75"	.75"	.94"
.375"	.75"	.75"	.94"
.500"	.75"	.75"	.94"

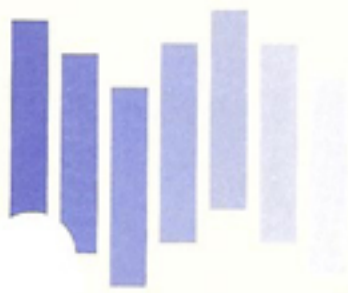

Immersion Transducers

The **Large Diameter Housing Style (ILD)** is the housing of choice for general purpose testing when element diameters greater than 1/2" are desired. This stainless steel housing features a water-proof UHF connector and an acoustically matched epoxy lens to optimize performance and prevent water intrusion.

The **Flange Housing Style (IF)** is designed to fit the 1.375" diameter search tube systems found in many immersion and squirter systems. The stainless steel housing and acoustically matched epoxy lens ensures optimum transducer performance and durability.

The ILD and IF housing styles are both available with spherical or cylindrical focusing to increase sensitivity to critical flaws or to improve near surface resolution. Please refer to the chart on page 22 for practical focusing limits.

A **Right Angle Reflector (ILD-RA)** is available for the ILD transducer to direct the sound beam 90° into hard to reach areas. Other angles available upon request.

Frequency (MHz)	Large Diameter Style			Flange Style
	.750"	1.00"	1.125"	
General Purpose Series (GP)				
1.0	ILD-0106-GP	ILD-0108-GP	ILD-0109-GP	IF-0106-GP
2.25	ILD-0206-GP	ILD-0208-GP	ILD-0209-GP	IF-0206-GP
3.5	ILD-0306-GP	ILD-0308-GP	ILD-0309-GP	IF-0306-GP
5.0	ILD-0506-GP	ILD-0508-GP	ILD-0509-GP	IF-0506-GP
10.0	ILD-1006-GP	—	—	IF-1006-GP
High Resolution Series (HR)				
2.25	ILD-0206-HR	ILD-0208-HR	—	IF-0206-HR
3.5	ILD-0306-HR	ILD-0308-HR	—	IF-0306-HR
5.0	ILD-0506-HR	ILD-0508-HR	—	IF-0506-HR
10.0	ILD-1006-HR	—	—	IF-1006-HR
Super Punch Series (SP)				
1.0	ILD-0106-SP	ILD-0108-SP	ILD-0109-SP	IF-0106-SP
2.25	ILD-0206-SP	ILD-0208-SP	ILD-0209-SP	IF-0206-SP
3.5	ILD-0306-SP	ILD-0308-SP	ILD-0309-SP	IF-0306-SP
5.0	ILD-0506-SP	ILD-0508-SP	ILD-0509-SP	IF-0506-SP

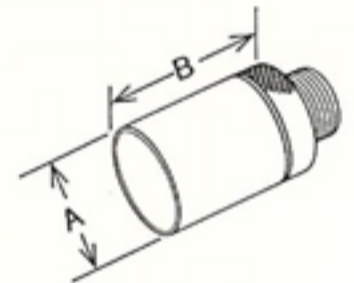
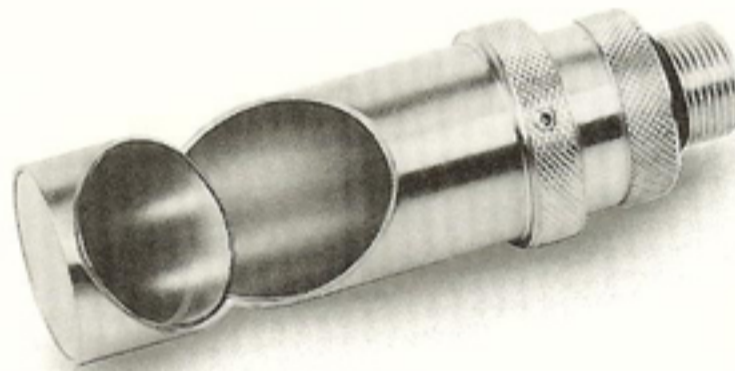

DIMENSIONS (ILD)		
Element	A	B
.75"	1.00"	1.38"
1.00"	1.25"	1.38"
1.125"	1.37"	1.38"

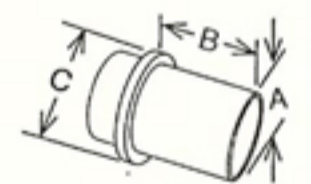
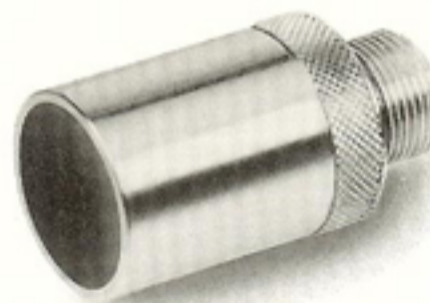

DIMENSIONS (IF)		
A	B	C
.990"	1.130"	1.20"

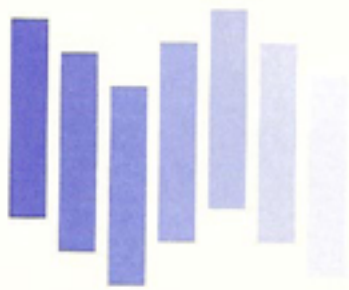

Immersion Transducers

Technisonic offers three pencil housing styles accommodating .250" diameter elements. All feature stainless steel housings and acoustically matched epoxy lenses for optimum transducer performance and durability.

The **IPM Model** is 1" long while the **IPML** is 1.5" long. A microdot connector is standard on both. These are ideal for applications where transducer size constraints are encountered.

The **IPU Style** features a knurled flange and a UHF connector for easy insertion into standard immersion systems. A right angle mounted element is available on special order.

The **IPM, IPML** and **IPU** are all available with spherical or cylindrical focusing to increase sensitivity to critical flaws or to improve near surface resolution. Please refer to the chart on page 22 for practical focusing limits.

A **Right Angle Reflector (IP-RA)** is available to direct the sound beam 90° into hard to reach areas. Other angles are available.



Frequency (MHz)	Style IPM	Style IPML	Style IPU
General Purpose Series (GP)			
2.25	IPM-0202-GP	IPML-0202-GP	IPU-0202-GP
3.5	IPM-0302-GP	IPML-0302-GP	IPU-0302-GP
5.0	IPM-0502-GP	IPML-0502-GP	IPU-0502-GP
10.0	IPM-1002-GP	IPML-1002-GP	IPU-1002-GP
Very High Resolution Series (VHR)			
10.0	IPM-1002-VHR	IPML-1002-VHR	IPU-1002-VHR
15.0	IPM-1502-VHR	IPML-1502-VHR	IPU-1502-VHR
20.0	IPM-2002-VHR	IPML-2002-VHR	IPU-2002-VHR
25.0	IPM-2502-VHR	IPML-2502-VHR	IPU-2502-VHR
High Resolution Series (HR)			
2.25	IPM-0202-HR	IPML-0202-HR	IPU-0202-HR
3.5	IPM-0302-HR	IPML-0302-HR	IPU-0302-HR
5.0	IPM-0502-HR	IPML-0502-HR	IPU-0502-HR
10.0	IPM-1002-HR	IPML-1002-HR	IPU-1002-HR
15.0	IPM-1502-HR	IPML-1502-HR	IPU-1502-HR
20.0	IPM-2002-HR	IPML-2002-HR	IPU-2002-HR
25.0	IPM-2502-HR	IPML-2502-HR	IPU-2502-HR

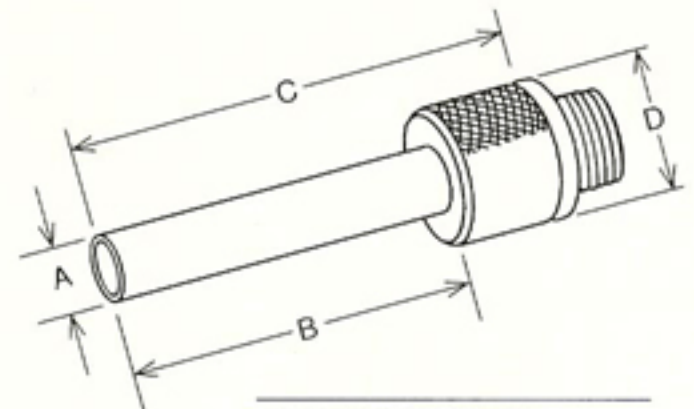

DIMENSIONS (IPU)			
A	B	C	D
.375"	2.00"	2.55"	.750"

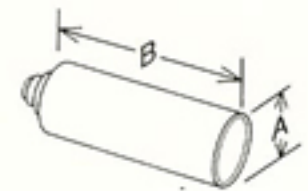

DIMENSIONS		
	A	B
IPM	.375"	1.00"
IPML	.375"	1.50"